

Family: Cooper | Item No. 4682

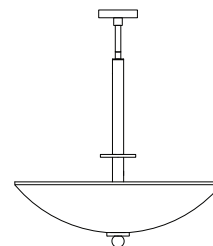

Drawing 1 - Assembly

## ▼ start here

1

1. Find a clear area in which you can work.
2. Unpack fixture and glass from carton.
3. Carefully review instructions prior to assembly.

**\*\*\* The construction of this fixture will be accomplished by first assembling the main body of the fixture, determining rod length, assembling the rods, attaching mounting assembly, hanging the fixture from the ceiling and then installing the glass.**

**SAFETY WARNING: READ WIRING AND GROUNDING INSTRUCTIONS (I.S. 18) AND ANY ADDITIONAL DIRECTIONS. TURN POWER SUPPLY OFF DURING INSTALLATION. IF NEW WIRING IS REQUIRED, CONSULT A QUALIFIED ELECTRICIAN OR LOCAL AUTHORITIES FOR CODE REQUIREMENTS.**

2

1. To assemble the main body (1), first slip center stem (2) along wire and thread into coupler (A) approximately 3/8". Thread hex nut (3) down and tighten against coupler (A) to lock center stem in position.
2. Slip center tube (4) over center stem (2), followed by tube cap (5).
3. Slip coupler (6) along wire and thread onto end of center stem (2) to finish column assembly.
4. To install diffuser (8), remove ball knobs (7) from socket cover plate (B) and thread ball knobs (7) back into holes to secure diffuser.
5. Line up holes in diffuser (8), with rolled edge facing down, with holes in socket cover plate (B) and thread ball knobs (7) back into holes to secure diffuser.
6. It is now necessary to determine the total lengths of rods (E) you will require to hang your fixture at the desired height. Fixture is supplied with a 4", 6", 12" and 24" rod.
7. After determining the rod lengths needed, slip them along the wire and thread the first rod into coupler (A). All subsequent rods (E) thread into each other.
8. Please refer to the hanging instruction sheet (I.S. 19-81) provided to hang fixture. Then refer back to this sheet to install glass.

3

1. To install glass (10), locate the large center hole (D) in the glass, onto the mounting plate (C) and hold in position. Assistance during the following steps recommended.
2. Slip cap (11) onto threaded center stem (9), followed by lockwasher (12). Hold parts and glass in position.
3. Thread hex nut (13) onto center stem (9) and tighten to secure glass.
4. Slip bottom cap (14) onto center stem (9) and hold in position.
5. Thread ball knob (15) onto end of center stem (9) and tighten to complete assembly.

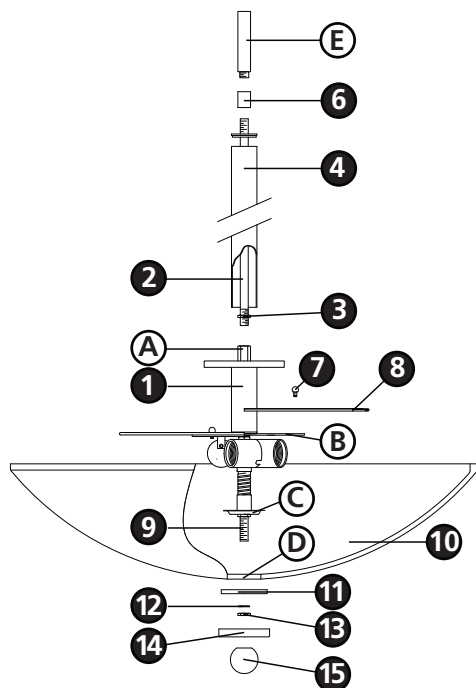

Drawing 1 - Fixture Assembly

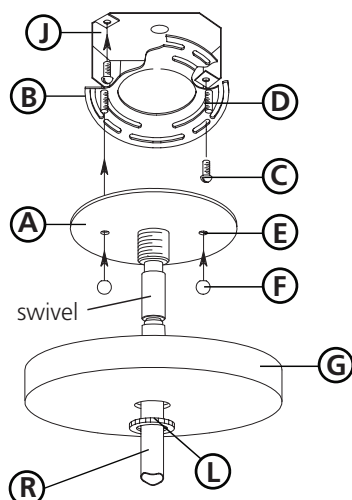

▼ start here

**SAFETY WARNING: READ WIRING AND GROUNDING INSTRUCTIONS (I.S. 18) AND ANY ADDITIONAL DIRECTIONS. TURN POWER SUPPLY OFF DURING INSTALLATION. IF NEW WIRING IS REQUIRED, CONSULT A QUALIFIED ELECTRICIAN OR LOCAL AUTHORITIES FOR CODE REQUIREMENTS.**

1

1. Shut off electrical current before starting. If the fixture you are replacing is turned on and off by a wall switch, simply turn the switch off. If not, remove the appropriate fuse (or open the circuit breakers) until the fixture is dead.

- DO NOT restore current - either by fuse, breaker or switch - until the new fixture is completely wired and in place.

2

- In the following order: take retainer ring (I) canopy (G) and slide them over the rods (R) attached previously.
- Slip mounting plate with swivel (A) along wires and thread into top of rods (R).
- Attach universal mounting strap (B) to the junction box (J) with screws (C) not provided.
- Slip holes (E) in mounting plate with swivel (A) over screws (D) in universal mounting strap (B).
- Thread ball knobs (F) onto screws (D) to secure fixture to universal strap (B).
- All necessary wiring can be done at this time. Please follow I.S. 18 for wiring instructions.
- Slip canopy (G) up along rods (R) and over mounting plate with swivel (A).
- Slip retaining ring (L) up to canopy and thread onto coupler (K), located on the mounting plate and swivel assembly, to secure parts.
- Return to assembly instruction to complete assembly of this fixture.

**Drawing 1 - Flush Mount**



**Drawing 2 - Chain Hung**



**Drawing 3 - Post-Mount**



## wiring instructions

### Indoor Fixtures

1. Connect positive supply wire **(A)** (typically black or the smooth, unmarked side of the two-conductor cord) to positive fixture lead **(B)** with appropriately sized twist on connector - see **Drawings 1 or 2**.
2. Connect negative supply wire **(C)** (typically white or the ribbed, marked side of the two-conductor cord) to negative fixture lead **(D)**.
3. Please refer to the **grounding instructions** below to complete all electrical connections.

### Outdoor Fixtures

1. Connect positive supply wire **(A)** (typically black or the smooth unmarked side of the two-conductor cord) to positive fixture lead **(B)** with appropriately sized twist on connector - see **Drawings 2 or 3**.
2. Connect negative supply wire **(C)** (typically white or the ribbed, marked side of the two-conductor cord) to negative fixture lead **(D)**.
3. Cover open end of connectors with silicone sealant to form a watertight seal.
  - If installing a wall mount fixture, use caulk to seal gaps between the fixture mounting plate (backplate) and the wall. This will help prevent water from entering the outlet box. If the wall surface is lap siding, use caulk and a fixture mounting platform specially.
4. Please refer to the **grounding instructions** below to complete all electrical connections.

## grounding instructions

### Flush Mount Fixtures

For positive grounding in a 3-wire electrical system, fasten the fixture ground wire **(E)** (typically copper or green plastic coated) to the fixture mounting strap **(1)** with the ground screw **(2)** - see **Drawing 1**.

Note: On straps for screw supported fixtures, first install the two mounting screws in strap. Any remaining tapped hole may be used for the ground screw.

### Chain Hung Fixtures

Loop fixture ground wire **(E)** (typically copper or green plastic coated) under the head of the ground screw **(2)** on fixture mounting strap **(1)** and connect to the loose end of the fixture ground wire directly to the ground wire of the building system with appropriately sized twist-on connectors - see **Drawing 2**.

### Post-Mount Fixtures

Connect fixture ground wire **(E)** (typically copper or green plastic coated) to power supply ground with appropriately sized twist-on connector inside post. Cover open end of connector with silicone sealant to form a watertight seal - see **Drawing 3**.